

Map for  
**STARCROSS™**

**INFOCOM™**

The next dimension

Infocom, Inc., 55 Wheeler St., Cambridge, MA 02138

**INFOCOM™**

STARCROSS is a trademark  
of Infocom, Inc.

© 1983 Infocom, Inc.  
Printed in U.S.A.

# CROSS SECTION AT THIRD RING

## LEGEND

——— NORMAL  
 CONNECTION  
 ———> ONE-WAY  
 CONNECTION  
 ..... CONNECTION  
 REQUIRING  
 PROBLEM SOLVING

U-UP      F-FORE      I-IN  
 D-DOWN    A-AFT      O-OUT

## NOTES:

TO AVOID UNNECESSARILY GIVING  
 AWAY PROBLEMS, ONLY OBJECTS  
 IMMEDIATELY VISIBLE UPON  
 ENTERING A ROOM ARE LISTED.  
 WHERE MORE THAN ONE DIRECTION  
 LEADS TO THE SAME PLACE, ONLY  
 ONE IS SHOWN.

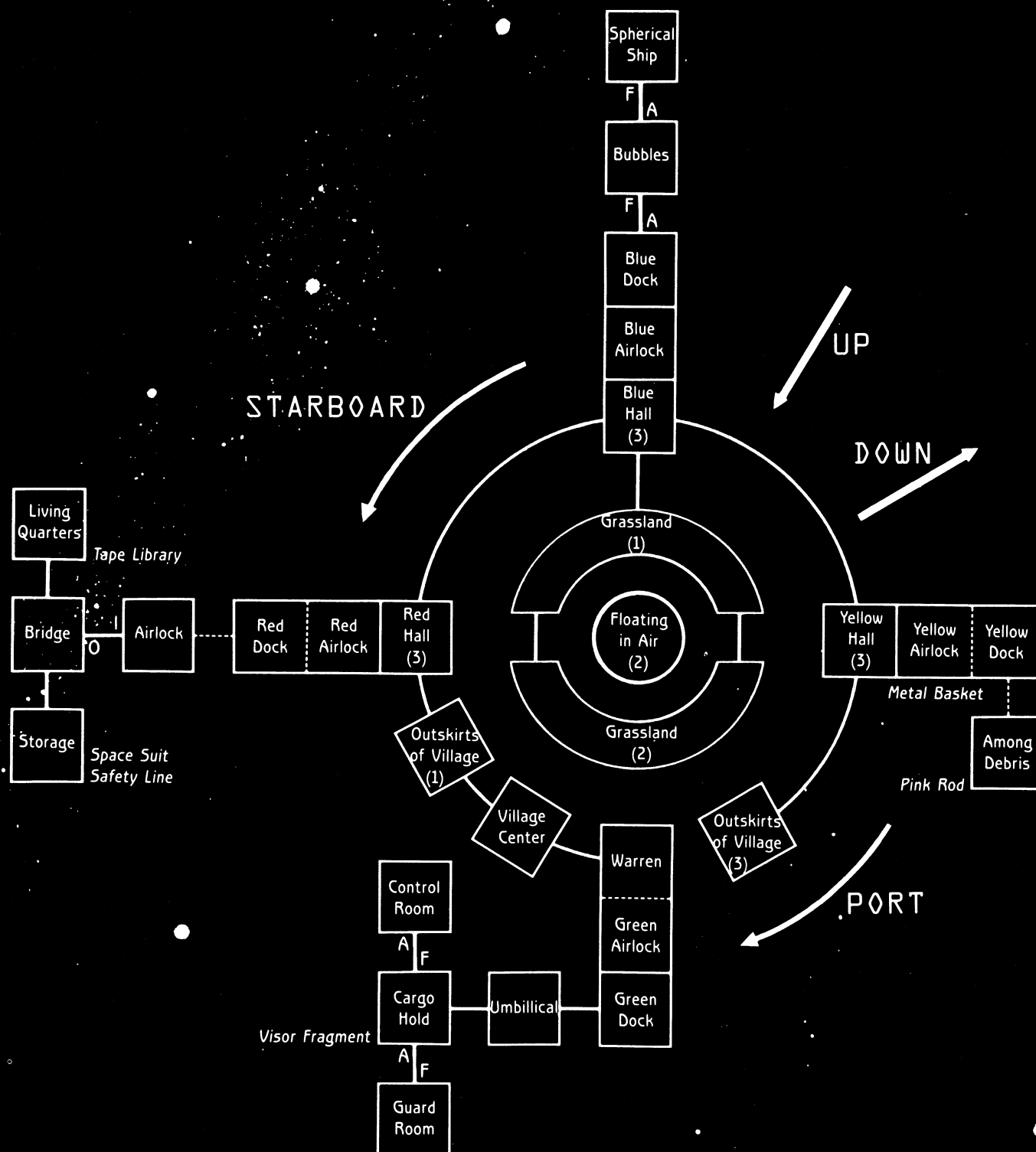

PORT

FORE END OF OUTER REGION

STARBOARD

TO BLUE HALL 1

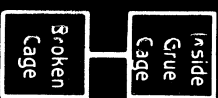
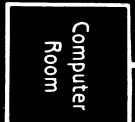
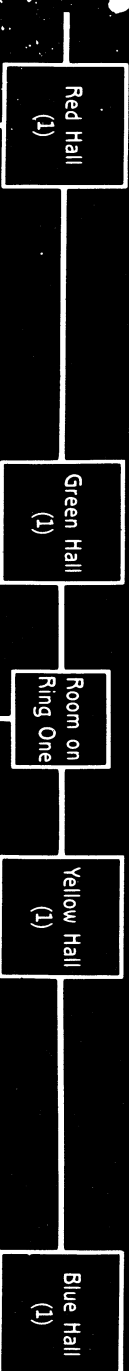

TO ROOM ON RING TWO



TO BLUE HALL 3

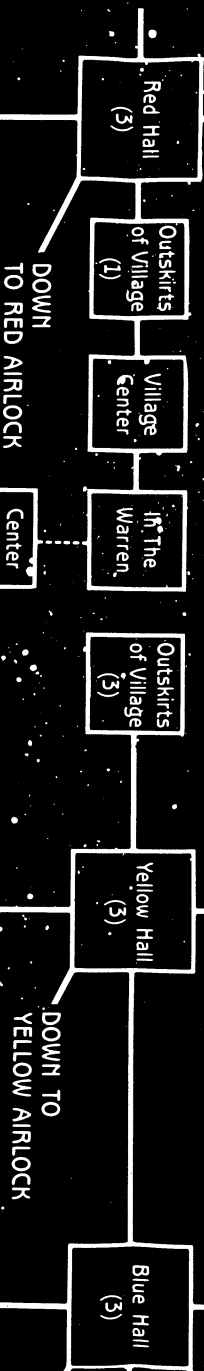

DOWN TO RED AIRLOCK

DOWN TO GREEN AIRLOCK

DOWN TO YELLOW AIRLOCK

DOWN TO BLUE 1



Ray Gun

TO ROOM ON RING FOUR

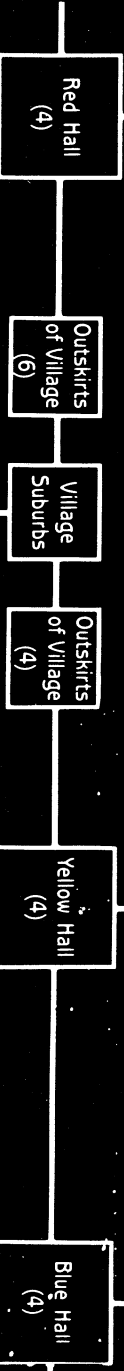

TO BLUE HALL 5

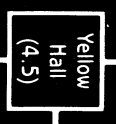

Blue Disk  
Red Disk

PORT

AFT END OF OUTER REGION

STARBOARD

BOARD —————>

TO RED HALL 1

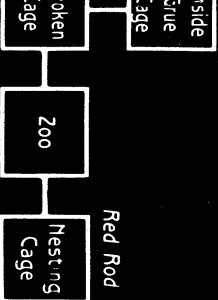

TO RED HALL 2

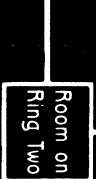

UP  
TO GRASSLAND 1

TO RED HALL 3

DOWN  
TO BLUE AIRLOCK

TO RED HALL 4

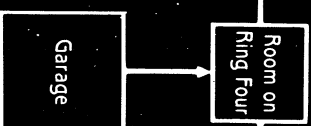

TO RED HALL 5



BOARD —————>

# FORE END OF INNER REGION

PORT STARBOARD

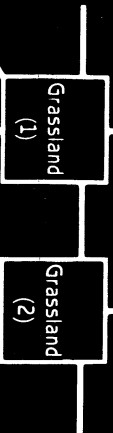
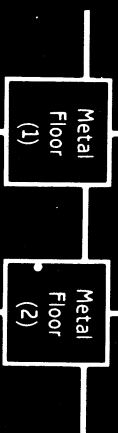
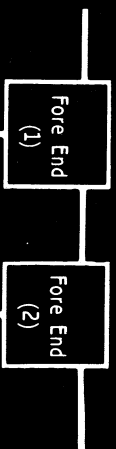
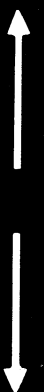

DOWN  
TO BLUE HALL 3

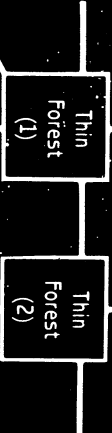

Meta & Ceramic Square

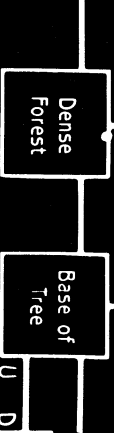

PORT STARBOARD



White Rod

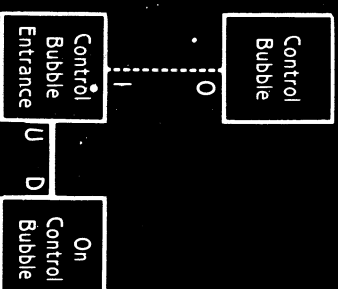
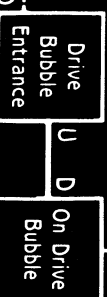

## STARCROSS

### LEGEND

- NORMAL CONNECTION
- ONE-WAY CONNECTION
- CONNECTION REQUIRING PROBLEM SOLVING

- U-UP A-AFT
- D-DOWN I-IN
- F-FORE O-OUT

### NOTES:

TO AVOID UNNECESSARILY GIVING AWAY PROBLEMS, ONLY OBJECTS IMMEDIATELY VISIBLE UPON ENTERING A ROOM ARE LISTED. WHERE MORE THAN ONE DIRECTION LEADS TO THE SAME PLACE, ONLY ONE IS SHOWN.



# AFT END OF INNER REGION